

PIXIE Gateway

#SGW3BTAM



Basic operation

- Press and hold for 5 seconds to reboot
- 9 clicks reset device

Applications

For out-of-home control, monitoring and voice assistant integration applications.

Whats in the box

1 x PIXIE Gateway, 1 x AC Adaptor, 1 x LAN cable, installation instructions

Accessories

Requires free PIXIE PLUS App to operate. Four LED indicators for clear status display & feedback.



SCAN ME

Download the PIXIE and
PIXIE PLUS Apps



#SGW3BTAM

PIXIE Gateway Gen3



This device is a bridge between the internet and the PIXIE Bluetooth mesh inside the home, introducing additional features and functionality such as out of home control and voice control capabilities. The Gen3 version introduces a LAN / RJ45 port for hard wired connections in addition to Wireless (2.4GHz) connectivity. The PIXIE Gateway Gen3 works with the PIXIE system and needs the free PIXIE Plus app.

Features

- Plug and play device with necessary AC adaptor included
- Choose between wireless or wired connection to local network
- PIXIE Connected Home Cloud for backup of PIXIE Home configuration
- Out of home control capabilities for the PIXIE smart home
- Integrate with voice assistants and other Cloud services and devices
- Schedule scenes, (as well as groups and devices as per the PIXIE App)
- PIXIE Gateway is an OPTIONAL device and is only needed if out-of-home control, scene scheduling or voice controls is desired.

Electrical

Input	15V DC - 1A
Operating ambient min/max (°C)	0 to 40°
Typical BT wireless range	15 metres typical indoors ^{✱✱}
IP Rating	IP20
Wi-Fi Connectivity	Wi-Fi 802.11 g/b/n, 2.4Ghz
LAN Port	1 x RJ45
Device Support	Up to 128 Gen3 Master

^{✱✱} Depending on building materials and construction.

PIXIE Gateway #SGW3BTAM



Related products

PIXIE Smart Dimmer
#SDD300BTAM



PIXIE 600W Switch
#SWL600BTAM



PIXIE Multifunction
#SMFBTAS



PIXIE Touch Panel
#STP54BTAS



Voice Assistant / System Compatibility

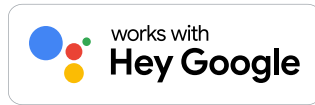

Product Detail

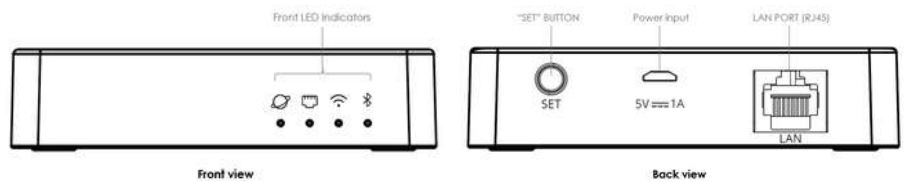

Indicator Status

Indicator	Internet	Lan (RJ45 port)	Wi-Fi	Bluetooth
Blink (once per 1 second) in red	This internet connection is waiting to be configured	This LAN (RJ45 port) connection is waiting to be configured	This Wi-Fi connection is waiting to be configured	This gateway is waiting to be configured
Solid red	Internet connection fail	Fail to connect to the router (local area network) via RJ45 port	Wi-Fi connection to the router (local area network) is failed	Bluetooth connection fail
Blink (once per 1 second) in blue	The internet connection is configuring	The LAN (RJ45 port) connection is configuring	The Wi-Fi connection is configuring	The Bluetooth connection is configuring
Blink slowly (once per 10 seconds) in blue	The gateway is currently working under offline mode (does not require internet connection to work)	The gateway is currently NOT using RJ45 port to connect to the router (local area network)	The gateway is currently NOT using Wi-Fi to connect to the router (local area network)	-
Solid blue	The internet connection is successful	The gateway is using RJ45 port to connect to the router (local area network), and the connection is successful	The gateway is using Wi-Fi to connect to the router (local area network), and the connection is successful	The Bluetooth connection is successful

PIXIE fits in

PIXIE fits in to a huge range of Australian wall plates



SCAN ME



SCAN ME

Download the PIXIE and
PIXIE PLUS Apps

